

West Bengal University of Technology

Tender Form

Setting up Laboratory

Notice No : LAB/FO/10-11/8
Date of Issue : 25-10-2010
D.D. No. for the Earnest Money :
D.D. No. for the Tender Price :

Address:

**BF-142, Sector-I,
Salt Lake City,
Kolkata-700 064**

Tele-Fax No:
(033) 2334-1034

Phone No.:
(033) 2321-1345

Tender Paper for Setting up Laboratory

Ref: Tender Notice No. LAB/FO/10-11/8 dated: 25-10-2010

1. a) Name & Address of the Firm :

b) Telephone No:

c) Mobile No.:

d) Fax No:

2. Name of the items for which the Firm is interested:

3. Name of the Proprietors/partners/directors etc:

4. Trade License No (With Photocopy):

5. VAT License No:

6. Service Tax Registration No (With Photocopy):

7. Additional Information if the party wants to include:

8. Copies of Testimonials/credentials/certificates regarding services/experience etc:

Signature with Stamp

Please give sealed quotation for the following jobs I and II, clearly superscribing the tender notice number on the envelop.
Job -I: Restructuring and furnishing of BIF Laboratory(Dept of Bioinformatics) at Room No. 216

Job description:

SL. No.	DESCRIPTION	UNIT
1.	Double Screen Partition – Providing & fixing double screen partition structure made by aluminium channel with 9mm ply & 6mm glass & laminets, teak wood liping & gala polish.	154 Sq.ft.
2.	Computer Table (Standard) – Providing & fixing computer table made by 19mm century ply & laminates, facilities of CPU, Monitor, Keyboard, UPS etc. teak wood liping & gala polish. Size- 42” x18” x30”. (MODULAR TYPE)	13 Nos.
3.	Computer Table (Big) - Providing & fixing computer table made by 19mm century ply & laminets, facilities of CPU, Monitor, Keyboard, UPS etc. teak wood liping & gala polish. Size- 44” x22”x30”. (MODULAR TYPE)	03 Nos.
4.	“L” Shape Table for Staff – Providing & fixing “L” shape table made by 19mm BWR ply & 1mm laminets, facilities of computer arrangement front side of table glass partition height of 18 inches. Size of main unit – 4’-6” x 1’-8” x 2’-6” & Extra unit – 24” x 16” x 30”. (MODULAR TYPE)	02 Nos.
5.	“L” Shape Table for Chamber – Providing & fixing “L” shape table made by 19mm BWR ply 1mm laminets teak wood liping & gala polish. Main Table Size- 66” x 36” x 30”. Extension unit size- 48” x 20” x 30”. (MODULAR TYPE)	1 No.
6.	Flooring – Providing & fixing PVC flooring of 2mm thick fixing & lacker	400 Sq.ft.
7.	Door Renovation – Providing & fixing main door renovation made by 6mm ply & laminets with teak wood liping & gala polish. Arrangement door closer make – Godrej.	1 No.
8.	Chair High Back – High Back Chair with P.U. arms. good quality P.U. foam tapestry. Iron base legs & nilon castors. Hydrolic system.	1 No.
9.	Medium Back Chair – medium back chair with P.U. arms. good quality P.U. foam tapestry. Iron base legs & nilon castors. Hydrolic system.	6 Nos.
10.	Aluminium Window – Providing & fixing Aluminium window with glass .	22 Sq. ft.
11.	Paint for Wall & Ceiling – Providing 2 coat primer & 2 coat paint (Royal Touch).	1080 Sq.ft.
12.	Wall fixing Filing Cabinet – Providing & fixing wall filing cabinet made by 19mm BWR ply & laminates with gala polish.	40 Sq. ft.
13.	Low back stools	16 nos.

Job -II: Electrical installation and LAN work of BIF Laboratory(Dept of Bioinformatics) at Room No. 216

Job description:

Sl no	Specification	Quantity
1	Distribution wiring in 2X1/1.40(1.5 sq mm) single core PVC insulated & sheated wire in 19 mm in black stove EI conduit to 3 pin 5A tumbler socket & switch with earthing attachment in No. 16 SWG GI wire and panting a) Average run 3 mtr	4 nos
2	Wiring for circuit / sub main wiring along with earth wire with the following size of PVC insulated copper wire in surface or recessed PVC conduit as required. a) 2x6sq mm +1x 2.5 sq mm earth wire	20 mtr
3	Wiring with 1.1KV grade single core stranded Al conductor PVC insulated and sheated wire in EI conduit and painting. a) 2x2.5 sq mm + 1x1.5 sq mm earth wire	20mtr
4	Wiring with 1.1KV grade single core stranded Al conductor PVC insulated and sheated wire in EI conduit and painting. a) 2x4 sq mm + 1x 2.5 sq mm earth wire	100 mtrs

5	Supplying and fitting fixing metal box of 180mm x 100mm x 60mm. deep (nominal size) on surface or in recessed with suitable size of phenolic laminated sheet cover in front incl. providing and fixing 6 pin, 3 no's 5/6 and 15/16 Amps. Socket outlet and 3 no's 15/16 Amps. modular type switch, connection, painting etc. as required. - ABB make	22 nos
6	Supply and fixing of 4 way double door vertical TPN DB box. (with out MCB) Make - ABB make	01 nos
7	Supplying and fixing 4 core 10 sq mm AL armoured cable	25mtrs
8	Supplying & fixing of SP MCB 10 A - ABB make	1 no's
9	Supplying & fixing of SP MCB 25 A - ABB make	1 no,s
10	Supplying & fixing of SP MCB 20 A - ABB make	11 nos
	1 no 16 A modular switch 1 no 16 A 5 pin modular socket suitable for 1 TR 1 no A.C.starter suitable for suitable for 1 TR 1 no G.I. box with plate of suitable size to accommodate the above	
11	Supplying & fixing of incoming 63A TPN MCB - ABB make	01 nos
12	Supply of Philips make light fitting FBS 450/236 P5 PW HF with 2 X PL-L 36 Watt	4 nos
13	Supplying and fixing LAN socket along with necessary accessories and fixing charges	24 no's
14	Wiring for lan points CAT - 6 LAN cable for internet connection and necessary termination.	200 mtrs
15	Supply of switch 24 port - Dlink	1 no
16	Installation, connection, commissioning and including everything completed of the light fittings.	4 nos

Design Layout of BIF lab (Dept of Bioinformatics) in Room No. 216

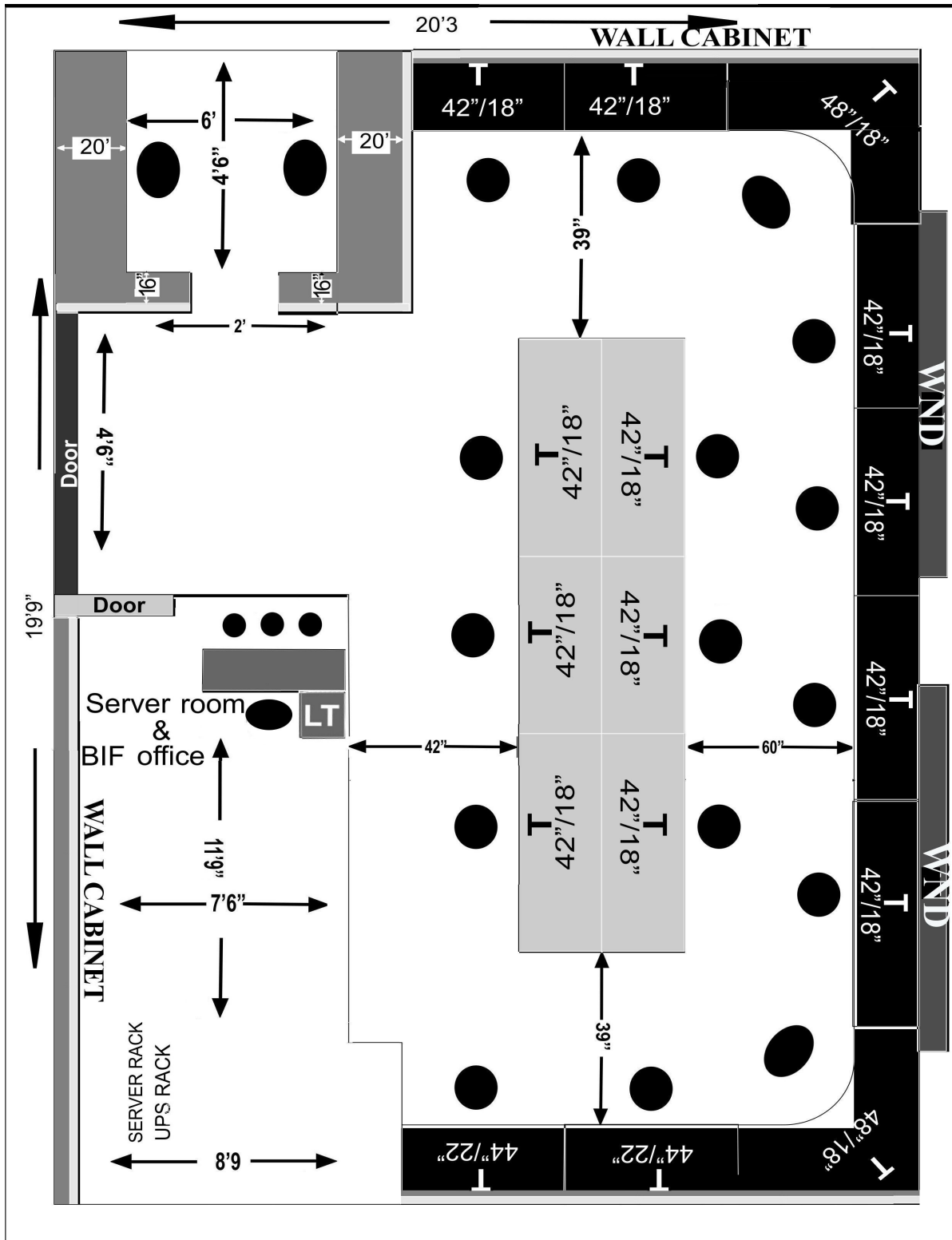

General conditions:

1. The tenderers are required to deposit the tender forms along with relevant papers(mentioned in the form) sealed cover.
2. The University reserves the right to accept or reject any tender without showing any reason.
3. Tender for supply of the goods mentioned in the notice may be submitted in full or in part.
4. Earnest money (refundable) of Rs. 2,000/- for each of the jobs shall have to be submitted along with the tender. The amount will be refunded within seven days of opening the tender.
5. Tender fee of Rs. 200/- has to be deposited along with the tender papers.
6. All payments should be made through demand drafts in favour of the 'West Bengal University of Technology' payable at Kolkata.
7. The last date of receiving of tender paper in the office of the Finance Officer is extended to **19th November 2010** before 3PM. The paper will be opened on the 22nd November 2010 at 3.00 PM.
8. Incomplete tender shall be summarily rejected.
9. Subcontracting in any form will not be entitled by the university.
10. All legal disputes shall be subject to jurisdiction of Calcutta High Court.